

MECHANICAL FLANGE SPREADER - PS 10 MANUAL

Friction-free, smooth and parallel wedge movement with unique interlock wedge design. Eliminates flange damage and risk of spreading arm failure.

USED IN: Mini Kit are used for shutdown, testing, pipe line maintenance, commissioning etc...

FEATURES:

- Manual Operation
- Required very small access gap of only 6mm
- Safety blocks and stepped blocks provide for more spreading distance
- Safe and reliable system

STANDARD KIT COMPONENTS

- 1 x MFS Wedge heads
- 1 x Safety Blocks
- 2 x Pair of Stepped Blocks
- 1 x Hex Key
- 1 x Ratchet Spanner
- 1 x Instruction Manual 1 x Carry Case

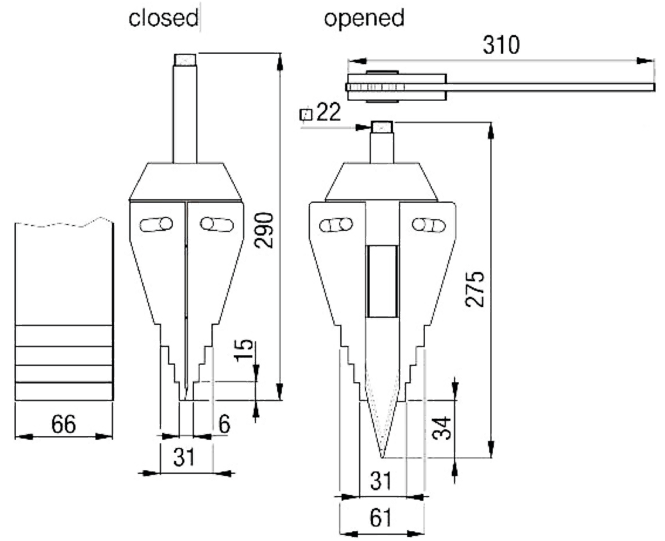

Maximum Spread Force	Tip Clearance	Maximum wt. Spread blocks	Tool Weight
10 (100 KN)	6mm	80mm	6.0 kg (15.4 lb)

LOW CLEARANCE HYDRAULIC FLANGE SPREADER

Features:

- 1) Secure Hold
- 2) No pinch points
- 3) Strength & Reliability of product
- 4) Max Working Pressure: 700Bar
- 5) Capacity: 5 and 10 Ton

Includes in Carry Case:

- 1 x Wedge head with threaded coupler
- 1 x 2m Hydraulic hose with threaded couplers on both ends
- 1 x 10000 PSI had pump, gauge, gauge adaptor & coupler
- 1 x Instruction manual
- 1 x Carry case

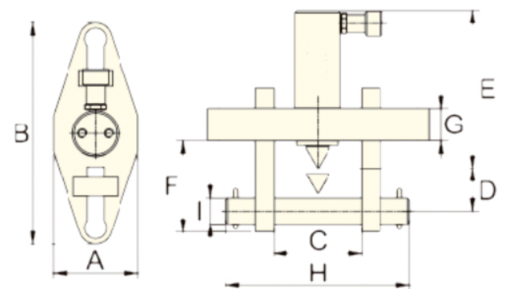

Model	Capacity (T)	Bolt Size (mm)	Flange Thickness (mm)	Stroke (mm)	Standard Wedge (mm)	Weight (kg)	Dimensions (mm)							
							A	B	C MIN-MAX		D	E	F	G
FF50STD	5	19-28	57(mm)	38	3-28 (mm)	11.5	76	209	70	155	32	196	88	25
FF100STD	10	31-41	92(mm)	54	3-28 (mm)	18	108	290	90	205	45	155	109	38

Model	Capacity(T)	Inserting Clearance (m)	Weight (kg)
TMGF7STD	6.8	2	5